

# OT19PP USA HC100 Version

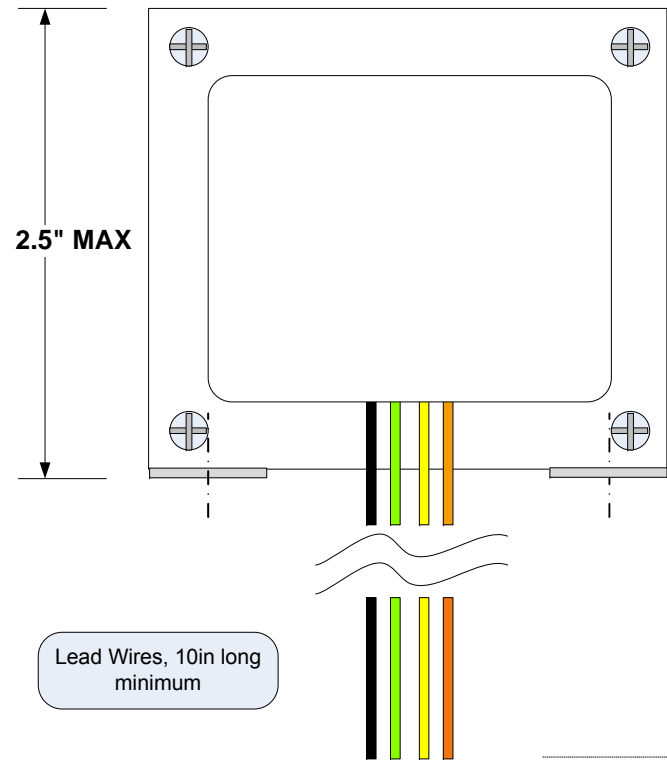

**OUTPUT Connections:**  
 Black<->Green 4Ω  
 Black<->Yellow 8Ω  
 Black<->Orange 16Ω

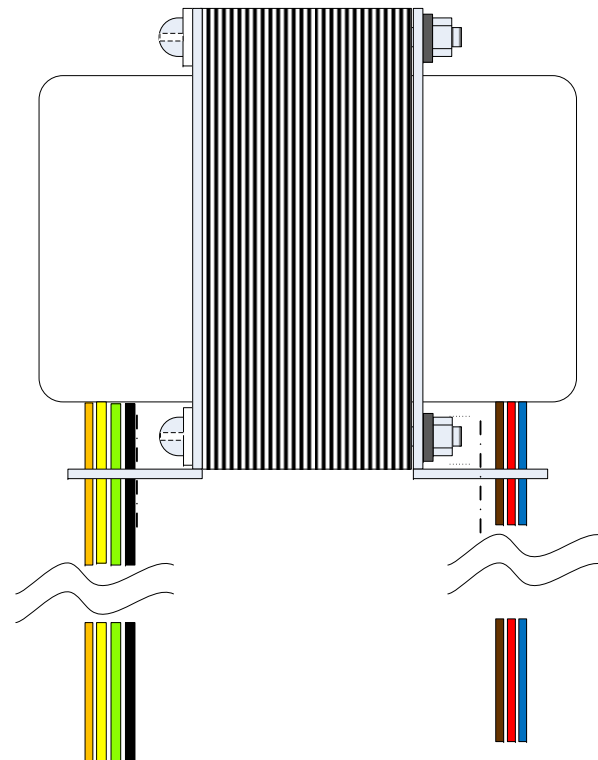

**INPUT CONNECTIONS:**  
 BRN<->BLU 8000 ohm P-P  
 RED is Center Tap

REF- BAHRS  
 HC100 End Bell

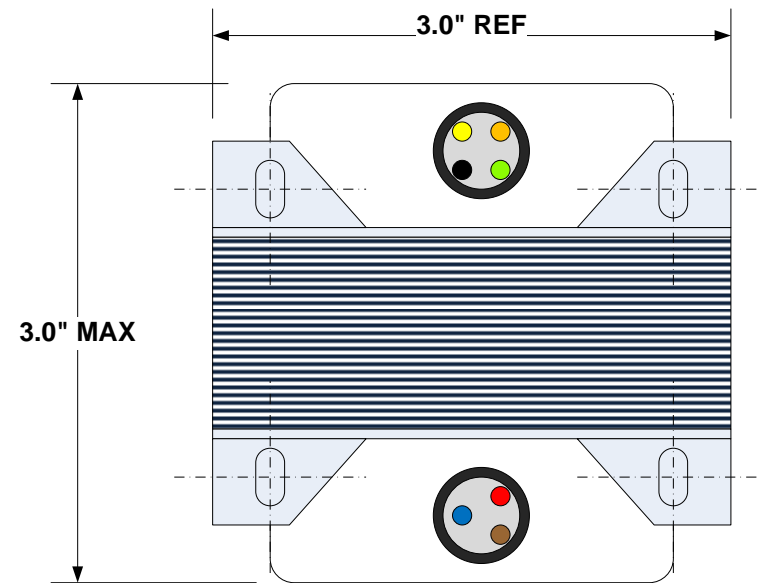
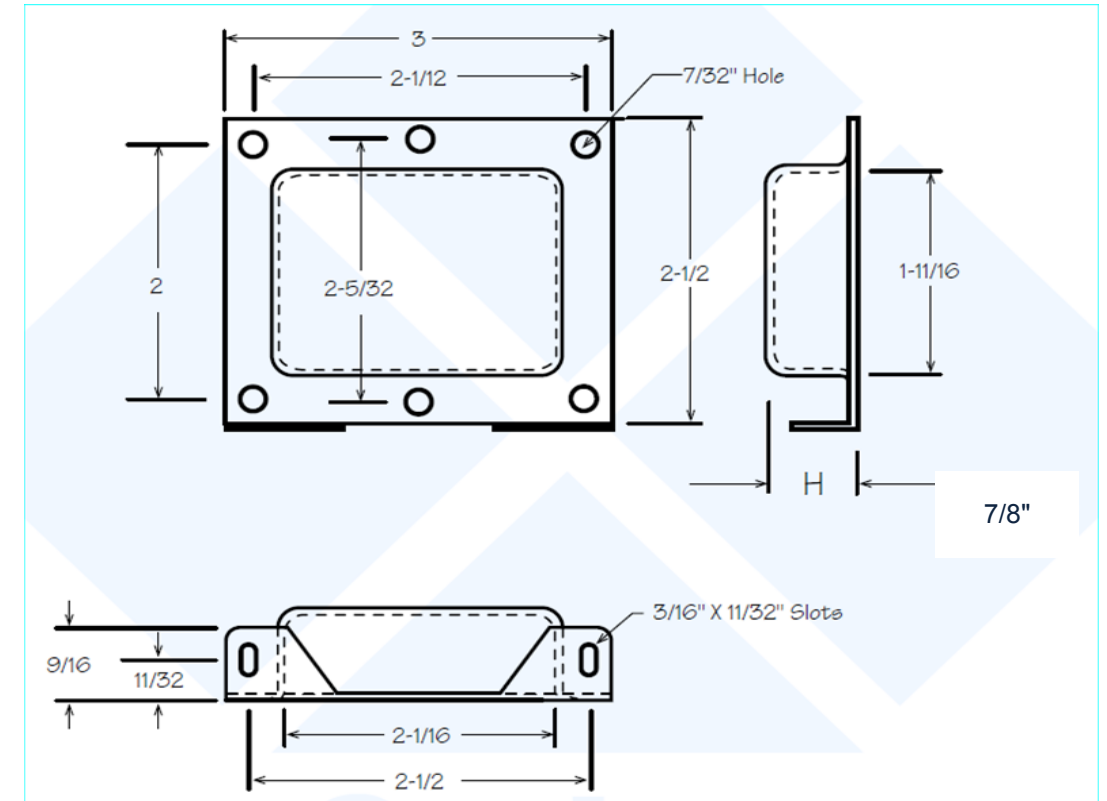

## Transformer Schematic OT19PP

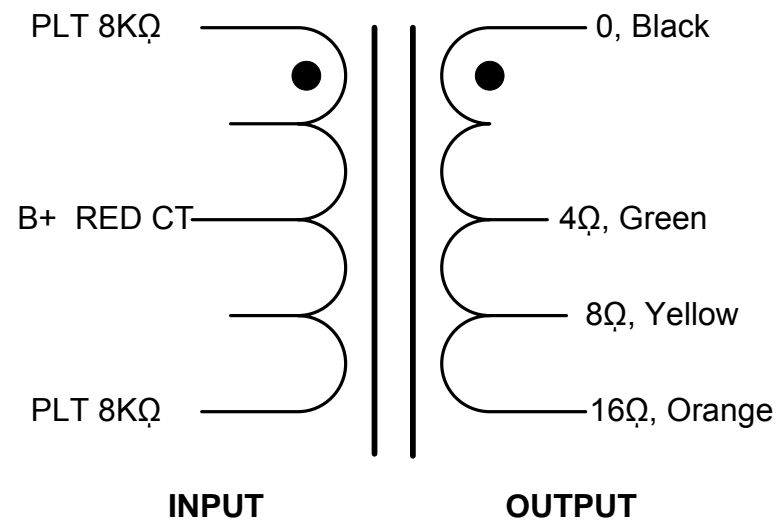

### CONSTRUCTION DETAILS-

Laminations: 29M6 x EI-100  
 Bobbin: EI-100 1 x 1.125 stack, Nylon Glass Reinforced UL94V-0  
 Winding: 5 layer interleave, 3X perfect layer output windings  
 Magnet Wire: MW80 155C or higher  
 Varnish- Class B 130C  
 Tapes: 3M #56 (inner) & #79 (outer wrap)  
 Frame: Bahr's USA Style 1- EI100 x 1.125  
 Weight: 2.5 Lbs

### PERFORMANCE

Operating Voltage 450Vdc Maximum  
 Output Power: 22VA Maximum  
 Designed Operating Frequency (+/-1dB): 35 to 15000 Hz  
 HiPot Test Ratings 1000Vac minimum  
 Input Impedances Plate to Plate: 8000 Ohms  
 Output Impedances: 4,8 and 16 Ohms  
 Application: 15 to 20W Push-Pull Amplifiers EL84



## OT19PP HC100 USA

05/04/2014	SIZE B	FSCM NO	DWG NO OT19PP USA STD	REV D
M.P.S.	SCALE	1 : 1	SHEET	Page 1 1 OF 1