

OT20SE USA HC100 Version

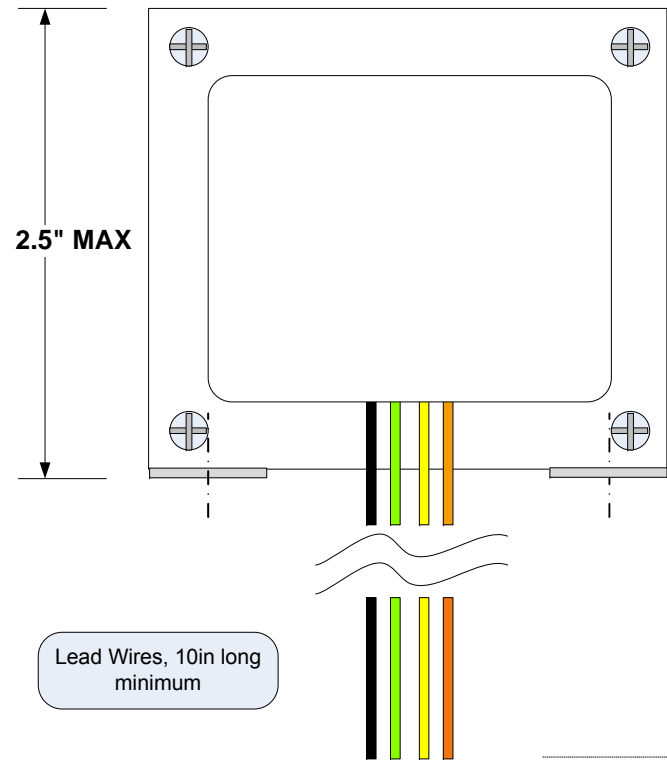

OUTPUT Connections:
 Black<->Green 4Ω
 Black<->Yellow 8Ω
 Black<->Orange 16Ω

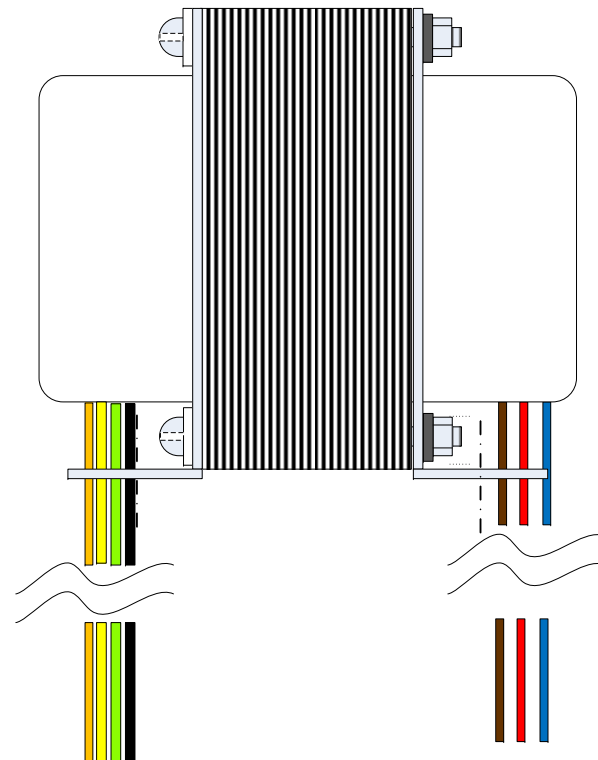

INPUT CONNECTIONS:
 RED<->BRN 2300 ohm SE
 RED<->BLU 3000 ohm SE

REF- BAHRS
 HC100 End Bell

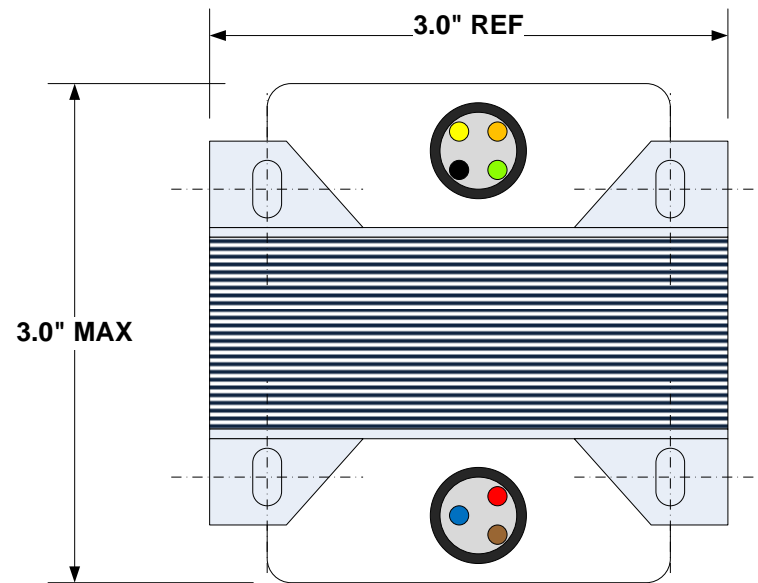
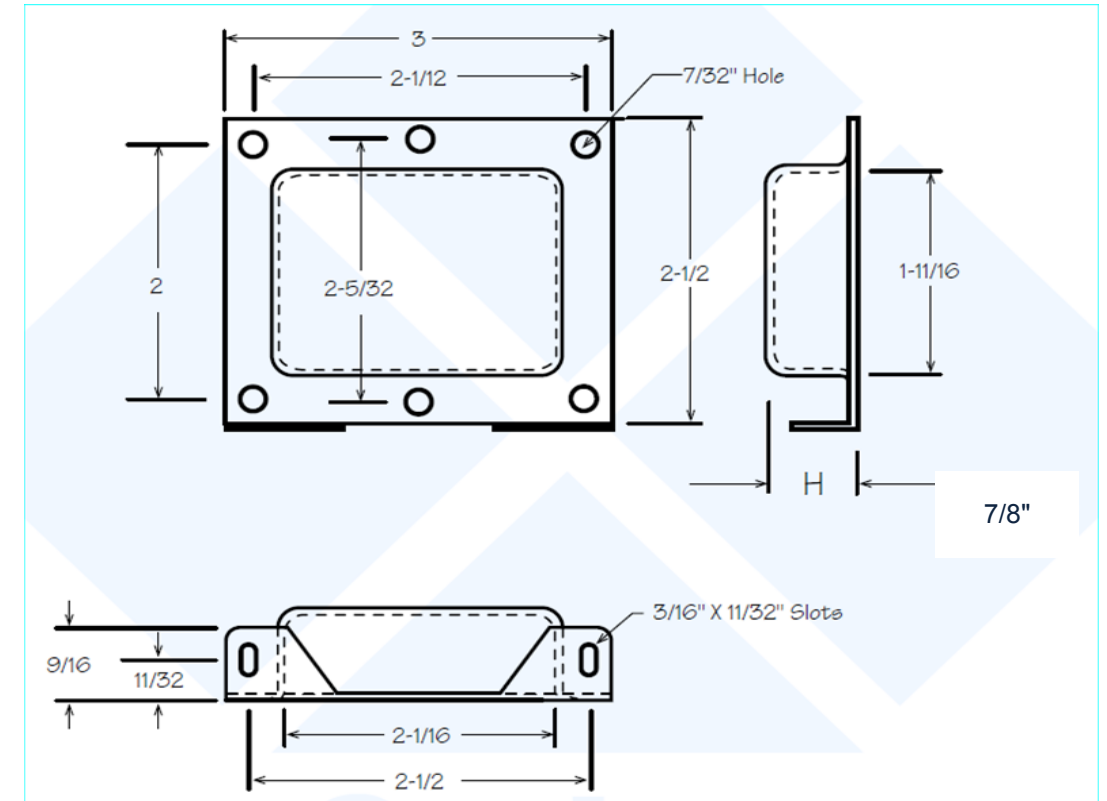

Transformer Schematic OT20SE

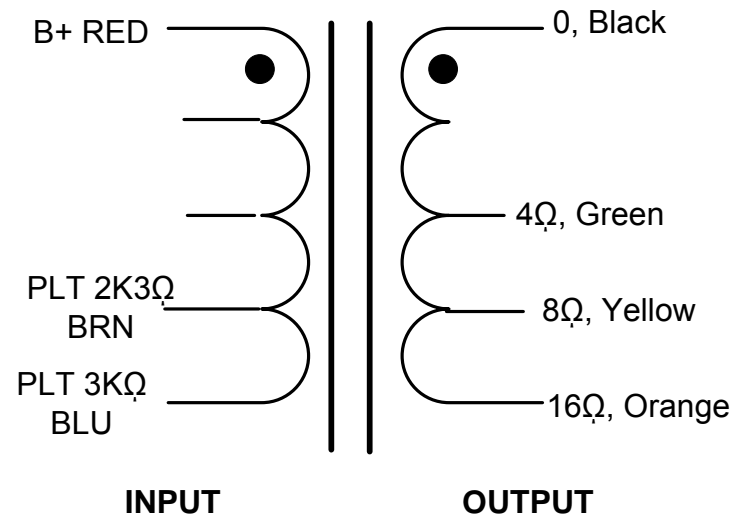

CONSTRUCTION DETAILS-

Laminations: 29M6 x EI-100, Butt Stacked with a GAP
 Bobbin: EI-100 1 x 1.125 stack, Nylon Glass Reinforced UL94V-0
 Winding: 3 layer interleave
 Magnet Wire: MW80 155C or higher
 Varnish- Class B 130C
 Tapes: 3M #56 (inner) & #79 (outer wrap)
 Frame: Bahr's USA Style 1- EI100 x 1.125
 Weight: 2.5 Lbs

PERFORMANCE

Operating Voltage 450Vdc Maximum
 Output Power: 20VA Maximum
 Designed Operating Frequency (+/-1dB): 45 to 15000 Hz
 HiPot Test Ratings 1000Vac minimum
 Input Impedances: 2300 or 3000 Ohms
 Output Impedances: 4,8 and 16 Ohms
 Application: 25 to 45W Push-Pull Amplifiers 6L6 family of Tubes



OT20SE HC100 USA

06/11/2014	SIZE B	FSCM NO	DWG NO OT20SE USA STD	REV D
M.P.S.	SCALE	1 : 1	SHEET	Page 1 1 OF 1